

Pan assembly for the Atlas

item	qty	part #	description
1	1	301106	PAN- ATLAS ACCESS
2	1	301400	ATLAS PAN GASKET
3	1	300919	WASHER- SEAL
4	1	300920	DRAIN PLUG- MAGNETIC
5	14	301401	BOLT 5/16 -18 X 1.00" FHHCS. NOTE: UNITS BUILT SEPT.2010 AND EARLIER (PRE 010500 SERIAL) USED A 3/4" BOLT AND THESE 1" BOLTS WILL NOT WORK.

Pan assembly for the Flat Tow Atlas

item	qty	part #	description
1	1	301106-P	PAN- ATLAS ACCESS W/ PICKUP TUBE
2	1	301400	ATLAS PAN GASKET
3	1	300919	WASHER- SEAL
4	1	300920	DRAIN PLUG- MAGNETIC
5	14	301401	BOLT 5/16 -18 X 1.00" FHHCS
	1	317212	PUMP PICKUP SCREEN-FOR ATLAS PAN
	3.5"	317213	PUMP PICKUP HOSE

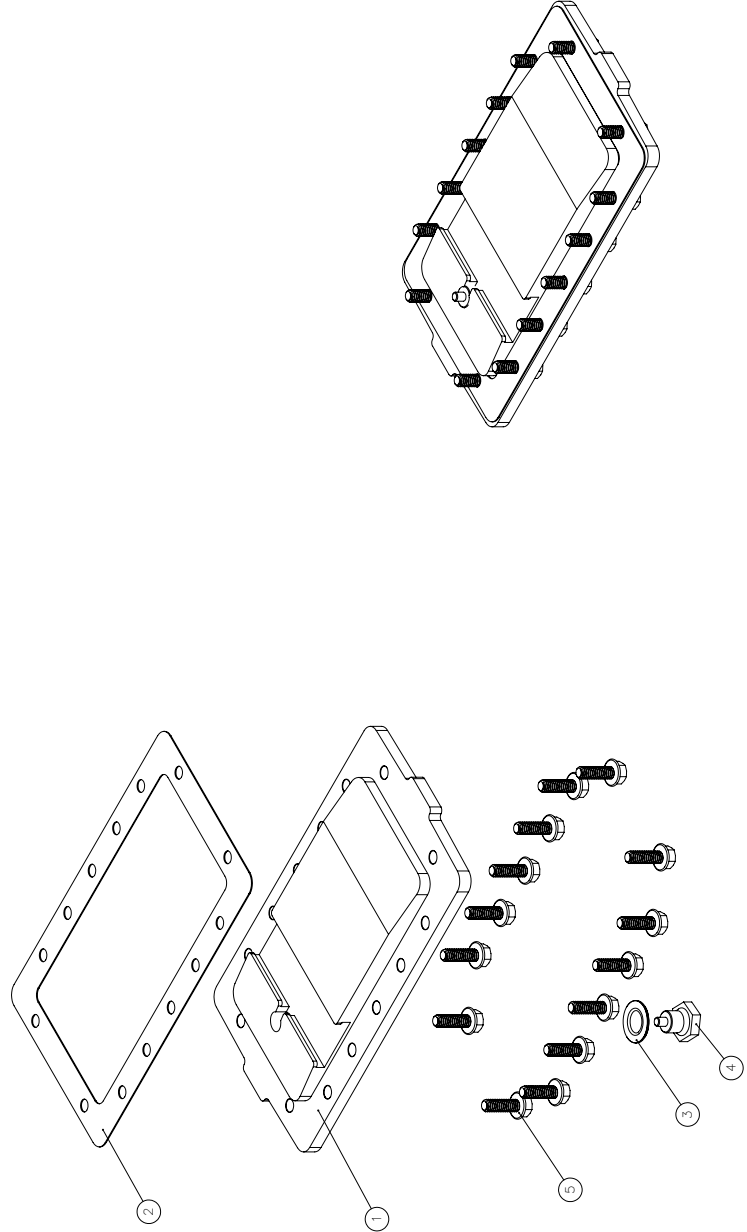



P.O. Box 247, 4320 Aerotech Center Way
Paso Robles, CA 93447
Telephone: (800) 350-2223 Fax: (805) 238-4201
PAGE 2 OF 2 Page Rev. Date: 04-05-18
P/N: Atlas Pan Assembly

Not many changes have happend to the Atlas pan. The most notable are the different fasteners used over the years, but the threads have always stayed the same. The design was changed once from a pan that had fins on the outside to the current model.

Assembly:

1. Clean the oil pan mounting flanges with solvent and a clean rag.
2. Even though we have a gasket for these mounting surfaces, we do recommend using RTV silicon in-addition to the gasket.
2. Install oil pan gasket, oil pan & bolts, use silicone on the threads of the mounting bolts.
- 2A. On the flat tow units, the oil pan will need the pickup screen installed into the pan and then connect the tube between the pickup and the main case fitting.

Note: We did use 3/4" long pan bolts for the several years. The bolts listed here are 1" long and will bot-tom out in the Atlas. Please double check your bolt length.

3. Torque bolts to 17 ft.lbs.
4. Install oil pan drain plug and washer. Torque to 10 foot-pounds.